



READY TO BUILD PLANS

TIMELESS WEATHERBOARD HOME

221.1M²

Cromwell

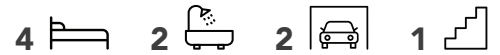

The Cromwell is a timeless weatherboard home with great aesthetic appeal. With three bedrooms and a study and computer nook, this is a classic family home. Open-plan living and bi-folding doors provide fabulous indoor-outdoor flow to the verandah. The central kitchen features a roomy walk-in pantry offering plenty of storage.

SPECIAL FEATURES

- Open plan living with central kitchen
- Walk-in pantry
- Wide verandah to entry and living areas
- Three bedrooms plus study
- Traditional exterior detailing and weatherboard cladding

DIMENSIONS

| | |
|--------------------|---------------------|
| Total Living Area | 177.1m ² |
| Garage Area | 44.0m ² |
| Total Floor Area | 221.1m ² |
| Porches | 21.7m ² |
| Total Area | 242.8m ² |
| Overall Dimensions | 25.2m x 16.0m |

