



READY TO BUILD PLANS

HOUSE OF SUNNY LIVING

168.4M<sup>2</sup>

# Accolade

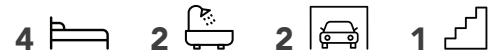

A compact and functional home, designed to catch morning and afternoon sun in the living areas, the Accolade has four bedrooms and two bathrooms packed into a well-planned footprint. Permanent materials and smooth lines make this home a classic design.

### SPECIAL FEATURES

- Well planned footprint for smaller sized sites
- Morning & afternoon sun captured in living areas
- 4 bedrooms and 2 bathrooms

### DIMENSIONS

|                    |                     |
|--------------------|---------------------|
| Total Living Area  | 129.0m <sup>2</sup> |
| Garage Area        | 39.4m <sup>2</sup>  |
| Total Floor Area   | 168.4m <sup>2</sup> |
| Porches            | 3.2m <sup>2</sup>   |
| Total Area         | 171.6m <sup>2</sup> |
| Overall Dimensions | 14.0m x 21.5m       |

